

FORM FIT Hood Protector

HD 20X18

Installation Instructions

Toyota CH-R 2018 up

Kit Contents

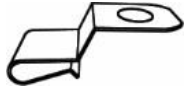

Metal mounting brackets (3)



Anti-abrasion pads (3)



#6 x 5/8" flat head screws (7)

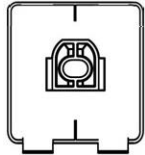

Adhesive pedestals (7)

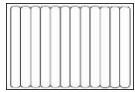

Re-usable tape strips (1)

Pins (7)



Bumpons (4)



Surface cleaner (2)



Installation tape measure (1)

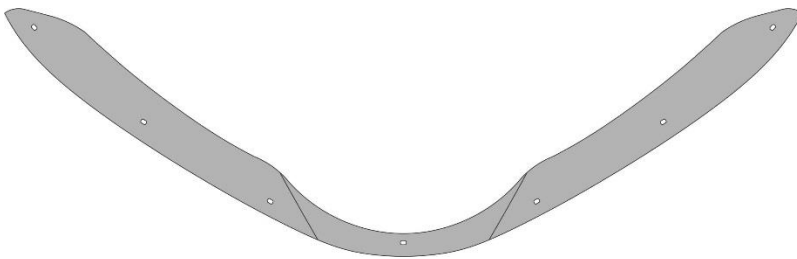

Hood protector (1)

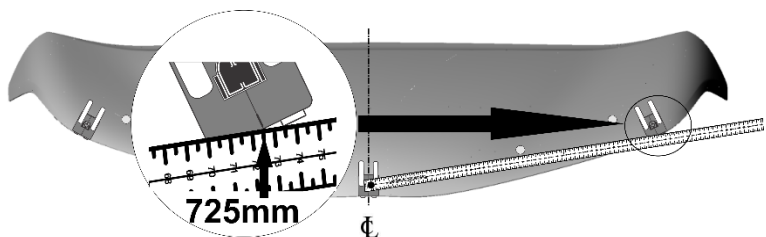
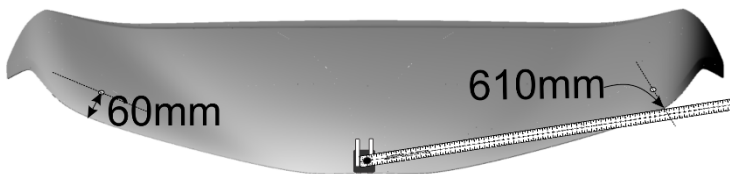
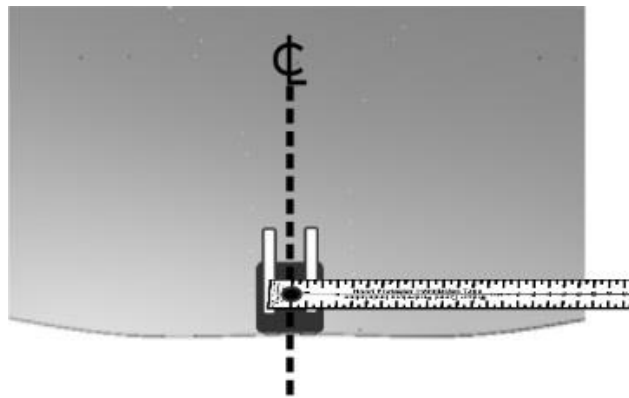
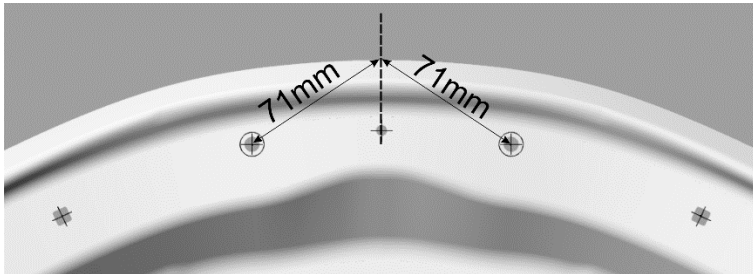
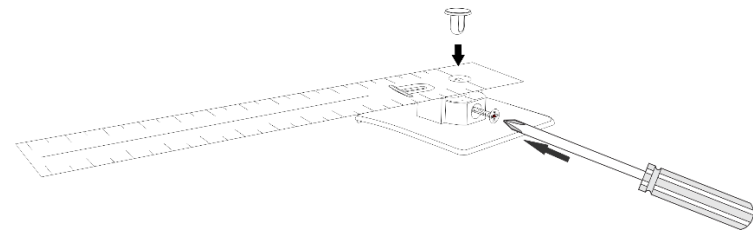

Installation Procedure

NOTE: Vehicle surface temperature should be a minimum of 15 degree Celsius.

1. Ensure the hood is clean and dry inside and out.
2. Insert a pin through the hole in the Hood Protector Installation Tape supplied and into an adhesive pedestal.
3. Install a #6 x 5/8 flat head screw into the pedestal and tighten as shown.
4. To find center, open the hood and locate three holes on the underside of the hood, close to the hood edge. The middle hole is centered on the hood. To confirm center at the edge of the hood, measure from the two holes to the sides of center to the hood edge as shown.
5. Temporarily mount the previously assembled pedestal and measuring tape at the center of the hood as shown.

6. Install the four (4) bumpons as shown.

⚠ Attention: Bumpons must be installed on the hood, not on the deflector!!!

7. Test fit the adhesive pedestals using the supplied tape strips or masking tape to temporarily hold them in position.

***The locations of the pedestals are as illustrated.

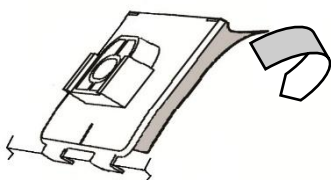
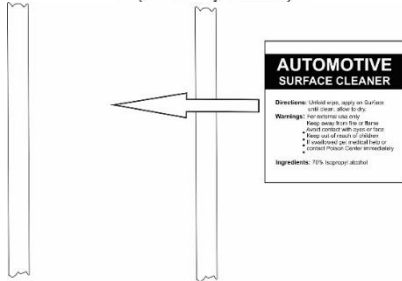
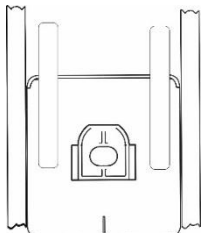
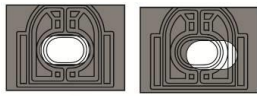
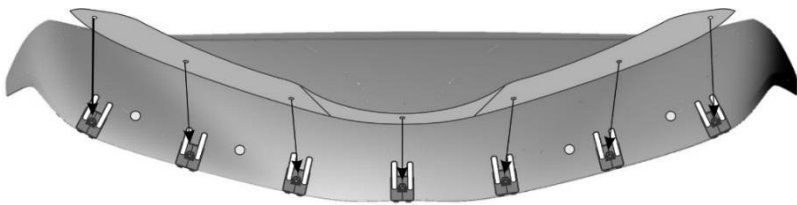
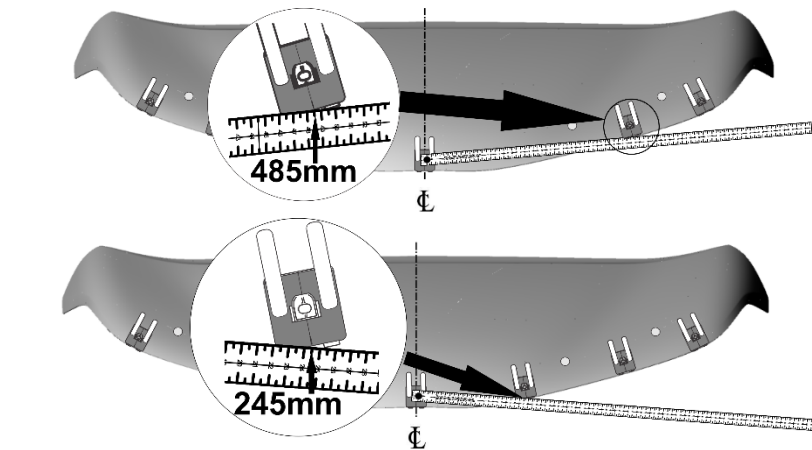

8. Place the hood protector onto the pedestals to confirm all attachment locations are aligned

- If necessary, reposition the pedestals so all attachment locations are aligned and the hood protector is centered

9. Remove the hood protector. Outline the perimeter of the adhesive pedestals with the tape strips or masking tape.

10. Remove the pedestals and thoroughly clean the outlined area with the automotive surface cleaner, followed by drying with a paper towel or clean cloth. This will ensure maximum adhesive bond by removing all surface contaminants.



11. One pedestal at a time, remove the red protective backing using caution to avoid contaminating the adhesive surface.

- Use tape outlines to correctly position the adhesive pedestals on the hood.
- Remove the tape outlines and “wet out” the adhesive to the hood surface by applying pressure with your thumb around the surface of the pedestals. This will ensure maximum adhesive bond.

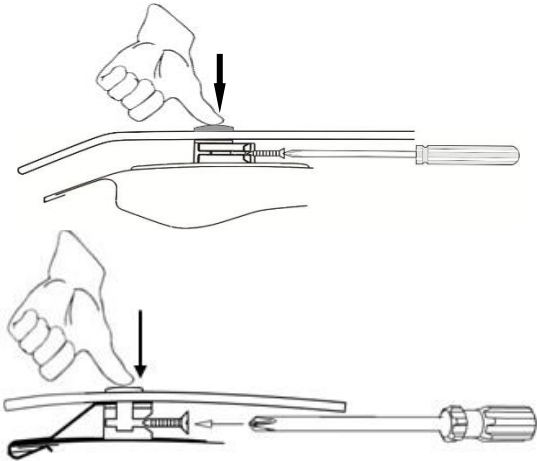
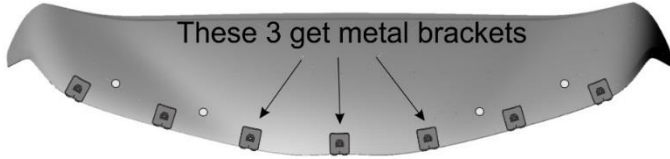
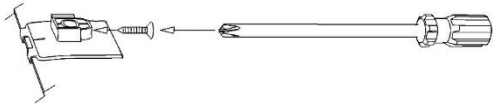

12. Start a screw into each pedestal a few turns. See illustration.



NOTE: The tip of the screw must not protrude into the hole where the attachment pin will install later.

13. Wrap abrasion pads as shown in the center three (3) locations as only these locations will receive a metal bracket.

14. Slide a metal bracket over the hood edge in the three (3) locations as indicated in the illustration.

15. Place protector onto the pedestals. Starting at center position working outwards, insert a pin through the protector and into each of the seven (7) pedestals. Maintain pressure on the head of the pin to ensure the protector is seated against the pedestal and tighten the screw until snug. Do not over-tighten!



CAUTION: Use caution to avoid damaging the hood surface while tightening the screws.



NOTE: Proper installation of the adhesive pedestal system requires the use of a #2 Phillips screwdriver, (long shaft). **See illustration.**

16. On some vehicles it may be necessary to adjust the hood bumpers and/or latch for proper clearance.

Note: Do not pull on the protector when opening or closing the hood.

CARE INSTRUCTIONS

Clean the protector with a mild soap and water solution or plastic cleaner only. Do not use chemicals or solvents. Periodically check to make sure the Bumpons are in place and the protector is secure. Do not pull on the protector when opening or closing the hood.